

# Town of Lyme Three Mile Bay

## WATER DISTRICT EXTENSION STUDY

Three  
Mile Bay

**BCA**  
ARCHITECTS  
ENGINEERS

# BCA Project Team

PRINCIPAL IN CHARGE: Gregor Smith, P.E.

PROJECT MANAGER: McKenzie Lehman, P.E.

**BCA**  
ENGINEERS  
ARCHITECTS

# District Boundary Map

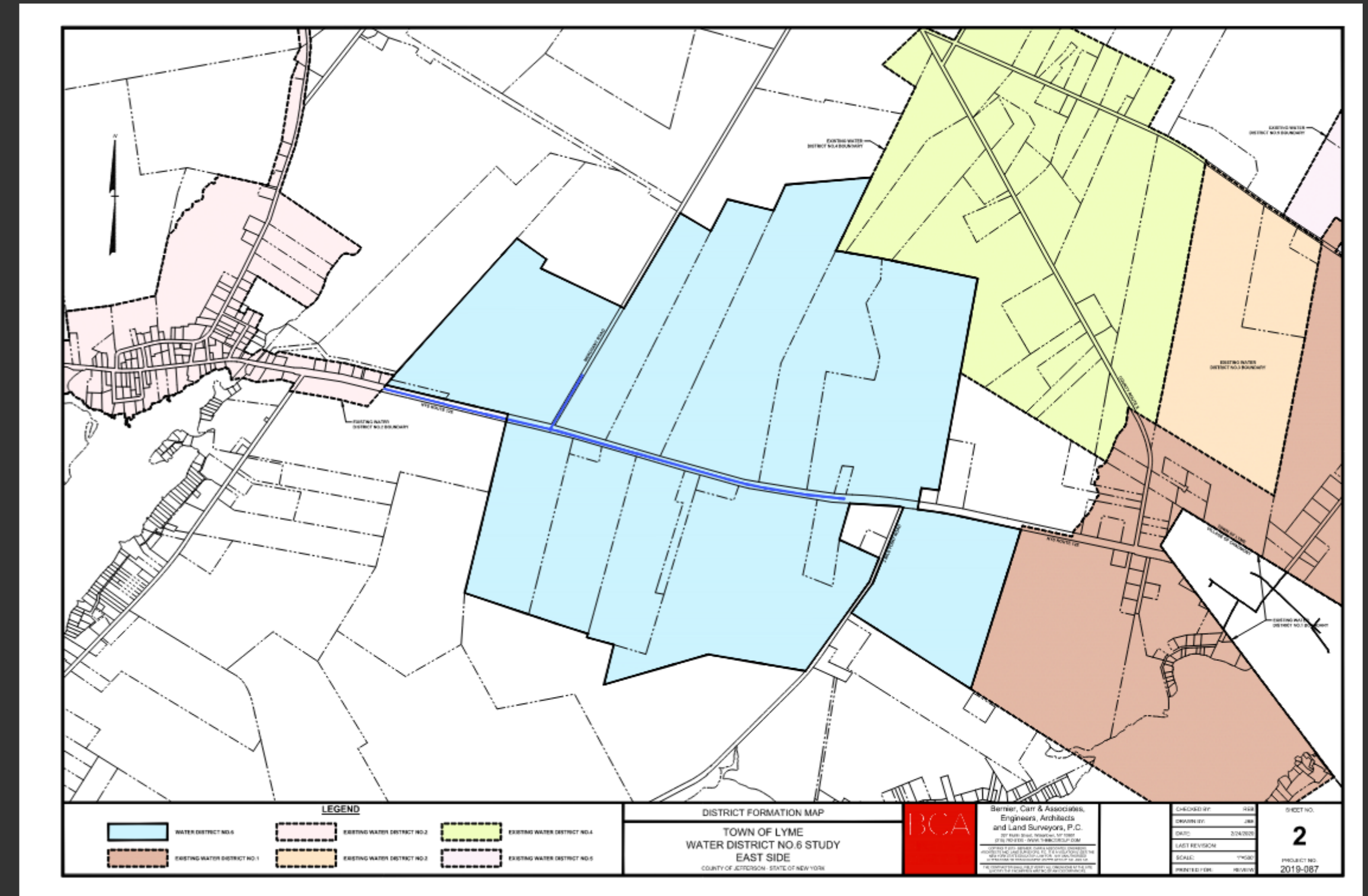
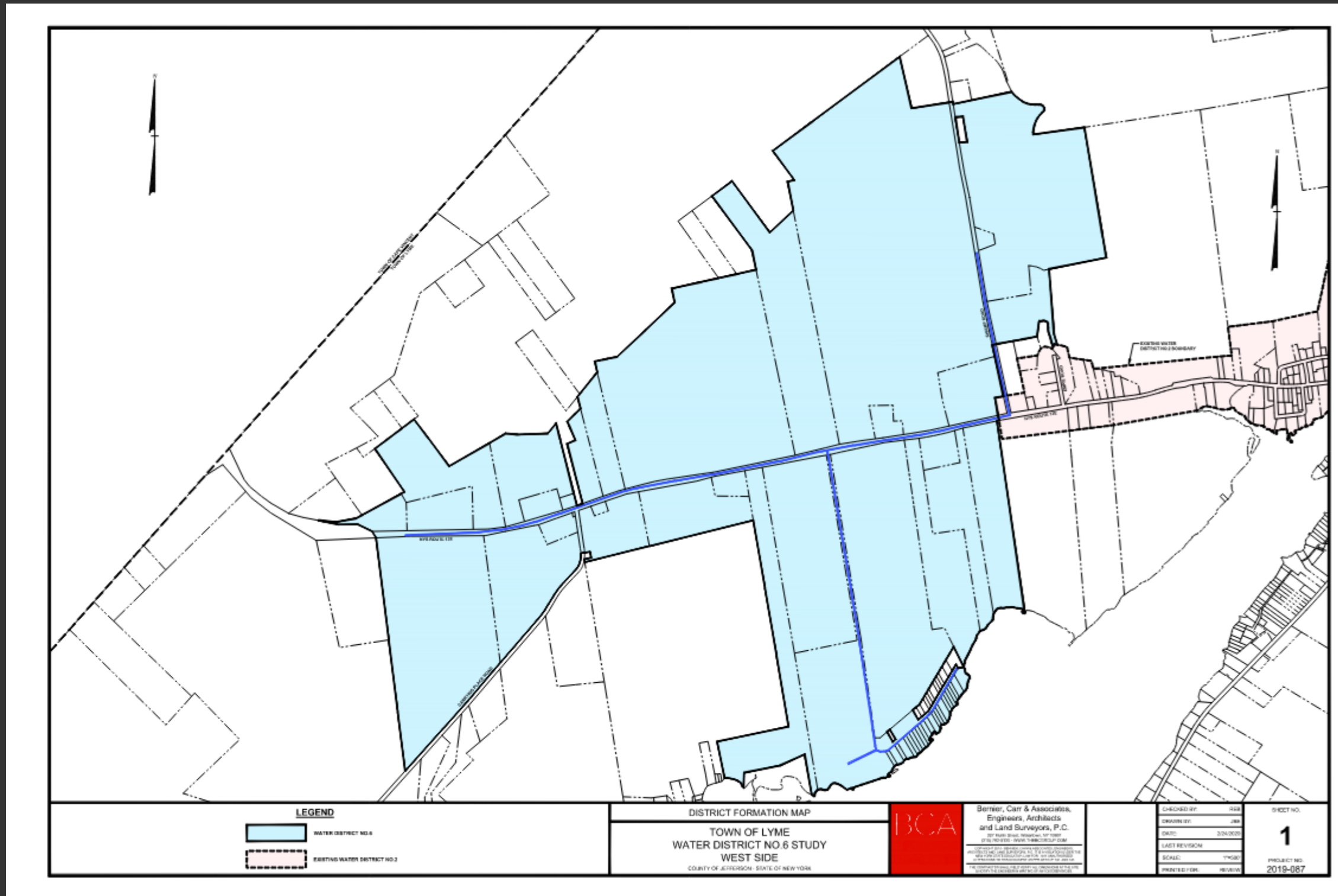

# Potential Funding Sources

## USDA Rural Development (USDA RD)

- Grants (max of 45% of project costs)
- Loans (~3% interest, 38 years)
- Rolling application period

## NYS Environmental Facilities Corporation (EFC) Drinking Water State Revolving Fund (DWSRF)

- Grants (\$5 million or 60% of project costs)
- Loans (low to 0% interest, 30 years)

## Community Development Block Grant (CDBG)

- Grants only (up to \$1,000,000 or \$1,250,000 with co-funding)
- Income survey required

## NYS Water Infrastructure Improvement Act (WIIA)

- Grants only (\$5 million or 60% of project costs)

## Open Market Borrowing

- Loans only

# POTENTIAL FUNDING SCENARIOS

- **EDU – Equivalent Dwelling Unit**
- **District EDUs**
  - **Existing Three Mile Bay Water District No. 2: 140**
  - **District Extension: 73**
  - **Total EDUs: 213**

# Opinion of Probable Costs

	Full Laterals	Laterals to Right-of-Way
<b>Total Project Cost</b>	<b>\$ 8,343,300.00</b>	<b>\$ 7,531,300.00</b>
NYS WIIA (60%, \$5m max)	\$ 5,000,000.00	\$ 4,518,780.00
USDA RD Grant (45% cap)	\$ 9,967.00	
USDA RD Loan (3%, 38-year)	\$ 3,333,333.00	\$ 3,012,520.00
Annual Debt Service	\$148,198.00	\$133,935.00
Number of EDUs	213	213
<b>Annual Debt Service per EDU</b>	<b>\$ 696.00</b>	<b>\$ 629.00</b>
<b>Bimonthly Debt Service per EDU</b>	<b>\$ 116.00</b>	<b>\$ 105.00</b>

\*Construction costs subject to change (e.g., inflation)

# Current Annual Costs per EDU

➤ <b>DANC Connection Charge</b>	<b>\$ 229.50</b>
➤ <b>Operation and Maintenance Costs</b> (includes short-lived assets)	<b>\$ 114.00</b>
➤ <b>Water Reserve Capital</b>	<b>\$ 18.00</b>
➤ <b>Water Reserve Operation and Maintenance</b>	<b>\$ 54.00</b>
➤ <b>Annual Water Usage</b> (assuming 150 gallons per day at \$2.55/kgal)	<b>\$ 140.00</b>
➤ <b>Existing Water District No. 2 Debt</b>	<b>\$ 210.00</b>
<hr/>	
➤ <b>Annual Total</b>	<b>\$ 765.50</b>
➤ <b>Bimonthly Total</b>	<b>\$ 128.00</b>

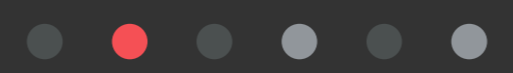

# Opinion of Probable Costs

	Full Laterals	Laterals to Right-of-Way
<b>Total Project Cost</b>	<b>\$ 8,343,300.00</b>	<b>\$ 7,531,300.00</b>
NYS WIIA (60%, \$5m max)	\$ 5,000,000.00	\$ 4,518,780.00
USDA RD Grant (45% cap)	\$ 9,967.00	
USDA RD Loan (3%, 38-year)	\$ 3,333,333.00	\$ 3,012,520.00
Annual Debt Service	\$148,198.00	\$133,935.00
Number of EDUs	213	213
<b>Annual Debt Service per EDU</b>	<b>\$ 696.00</b>	<b>\$ 629.00</b>
<b>Bimonthly Debt Service per EDU</b>	<b>\$ 116.00</b>	<b>\$ 105.00</b>
DCC	\$ 229.50	\$ 229.50
O&M	\$ 114.00	\$ 114.00
Reserve Capital	\$ 18.00	\$ 18.00
Reserve O&M	\$ 54.00	\$ 54.00
Annual Water Usage	\$ 140.00	\$ 140.00
Water District No. 2 Debt Repayment	\$ 138.00	\$ 138.00
<b>Total Annual Cost per EDU</b>	<b>\$ 1,390.00</b>	<b>\$ 1,323.00</b>
<b>Bimonthly Annual Cost per EDU</b>	<b>\$ 232.00</b>	<b>\$ 221.00</b>

\*Construction costs subject to change (e.g., inflation)

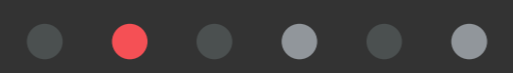



# QUESTIONS?

**BCA**  
ARCHITECTS  
ENGINEERS